

Noon handrinse



The smallest bowl in our Noon collection is the Noon handrinse. This handrinse basin can be used as a countertop model or wall-mounted by using our white powder coated bracket.

Noon handrinse is designed with its own matching white Hi-Macs drain cover to gently merge with the soft rounded shape of the bowl.

Design by Marike Andeweg

Specifications

- HNN01 is top-mounted
- HNN02-04 comes with a white powder coated bracket
- HNN03-04 tap hole Ø30mm
- HNN10-14 tap hole Ø30mm; for UK Ø35mm

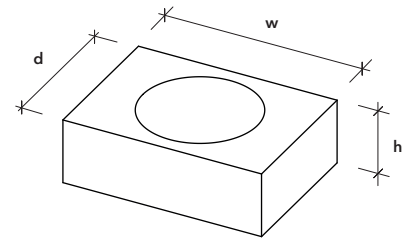
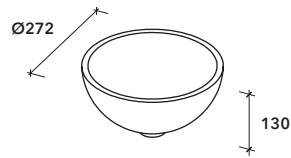

HNN01
Ø272 x h130mm



HNN10
w430 x d310 x h135mm
bowl Ø248 x h116mm

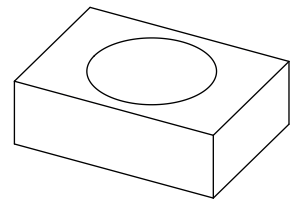

HNN02
Ø272 x h130mm

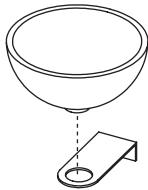

HNN11
w430 x d310 x h135mm
bowl Ø248 x h116mm

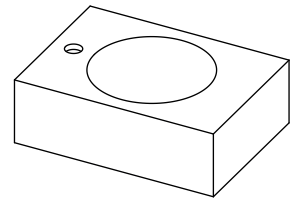

HNN03
Ø272 x h130mm

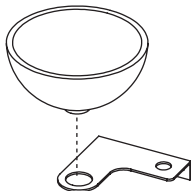

HNN12
w430 x d310 x h135mm
bowl Ø248 x h116mm

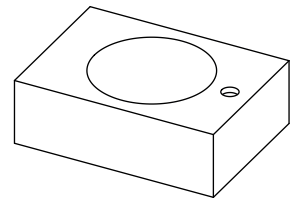

HNN04
Ø272 x h130mm

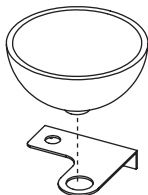

HNN13
w600 x d310 x h135mm
bowl Ø248 x h116mm

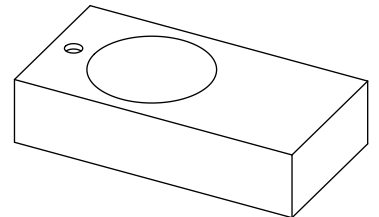

HNN14
w600 x d310 x h135mm
bowl Ø248 x h116mm

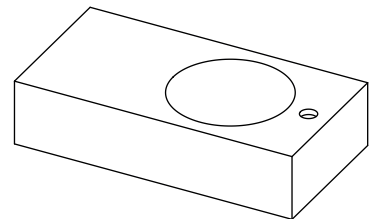

Materials and colours

Hi-Macs

White

Steel

White powder coated

Handrinse layout

Fill in positions 1-5.

- ① max. 5000mm
- ② max. 400mm
- ③ min. 35mm
min. 90mm with tap hole
- ④ min. 30mm
- ⑤ min. 30mm
min. 80mm with tap hole

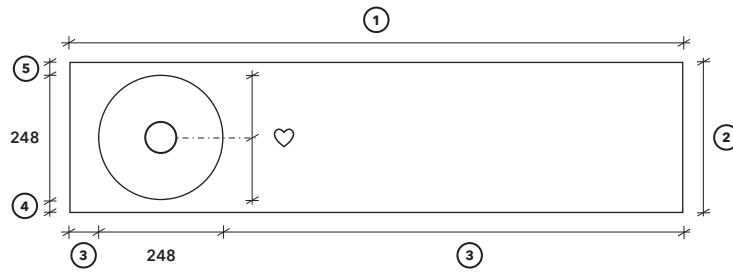

Edge

Noom handrinse can come with a front and back edge. In order to conceal the bowl, Not Only White recommends an edge height of 135mm.

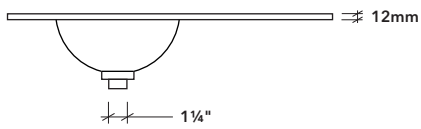

H12
12mm top sheet

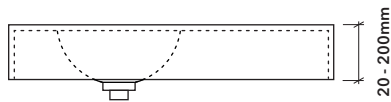

EH100
Edge 20 - 100mm high

EH150
Edge 101 - 150mm high

EH200
Edge 151 - 200mm high

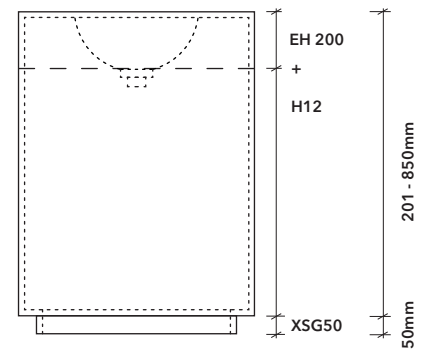

EH200 + remaining m² in H12
Edge 201 - 850mm high

XSG50
50mm plinth for floor-standing model

Bowls

CHNN01
 Ø248 x h116mm
 rec. edge height 135mm



Drain type

Depending on how the handrinse basin needs to look and work, you can choose from different drain types for Noon handrinse.

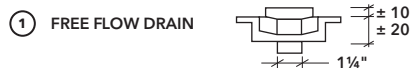

Noon handrinse bowls are standard equipped with a free flow drain. This drain allows water to flow through at all times and cannot be closed.

Free flow drain is free of charge

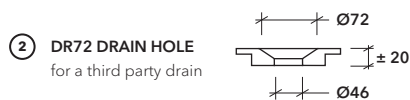

The DR72 drain hole is used for third party drains.

Not Only White recommends to use a free flow drain.

DR72 drain is free of charge

Overflow

An overflow is not possible.

Tap hole

If you need to fit a top-mounted tap, we can pre-drill the hole (code **HH35**).

Consider the space you would need to secure the tap with a tightening ring.

Top-mounted tap without overflow:

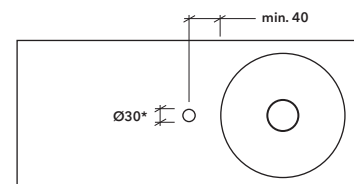

* Tap hole for UK Ø35mm

Brackets and ribs

Please refer to page 11, where brackets and ribs are explained, to find out what type of support is needed for your washbasin.

Cut-outs and edge finishes

Please refer to page 10.

Materials and colours

Hi-Macs White