

Noon



Noon is a friendly and bowl-shaped basin made out of Hi-Macs that can be placed on top of our Flat shelf or Stoore and Grid cabinet. The foot elevates the Noon from the surface, allowing for easy maintenance and adding an extra dimension to its appearance.

Noon is available in three countertop Models and also in an undermounted Made to Measure design.

○ White

Noon

Noon Models

Specifications

- with our Flush drain
- Noon countertop bowl should be fixed on top of a surface using flexible silicon
- Noon FNN10-12 Models are floor-standing models including a removable access panel
- Noon FNN10-12 Models have a 50mm high plinth



FNN364 (prev. FNN03)
Ø364 x h150mm
inside Ø340 x h114mm



FNN424 (prev. FNN01)
Ø424 x h160mm
inside Ø400 x h124mm



FNN484
Ø484 x h170mm
inside Ø460 x h134mm



FNN10
Ø400 x h900mm
inside Ø340 x h114mm

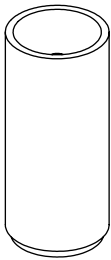

FNN11
Ø460 x h900mm
inside Ø400 x h124mm

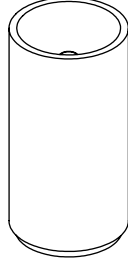

FNN12
Ø520 x h900mm
inside Ø460 x h134mm



Specifications

- with our Flush drain
- delivered as wall-mounted version including necessary brackets
- Noon Models are also available in top-mounted versions

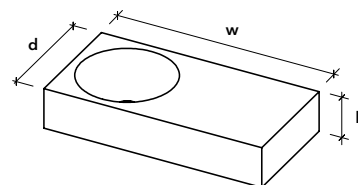

d400mm

FNN31
w800 x d400 x h150mm
bowl Ø340 x h114mm

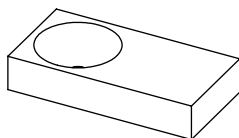

FNN32
w800 x d400 x h150mm
bowl Ø340 x h114mm

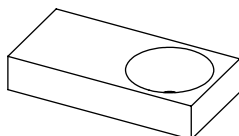

FNN33
w1200 x d400 x h150mm
bowls Ø340 x h114mm

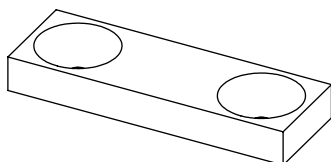

d520mm

FNN51
w1000 x d520 x h150mm
bowl Ø460 x h134mm

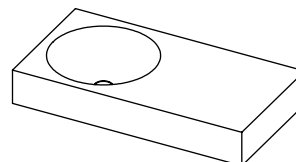

FNN52
w1000 x d520 x h150mm
bowl Ø460 x h134mm

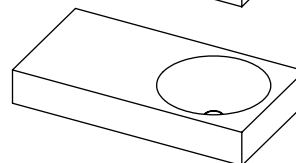

FNN53
w1600 x d520 x h150mm
bowls Ø460 x h134mm

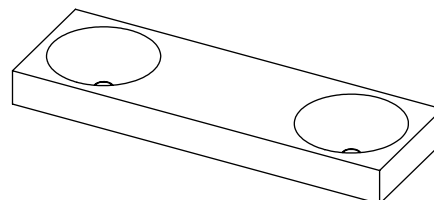

d460mm

FNN41
w900 x d460 x h150mm
bowl Ø400 x h124mm

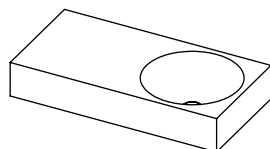

FNN42
w900 x d460 x h150mm
bowl Ø400 x h124mm

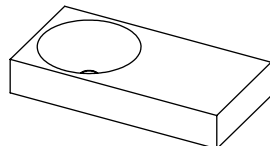

FNN43
w1400 x d460 x h150mm
bowls Ø400 x h124mm

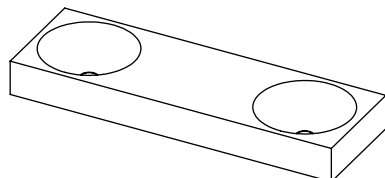

Washbasin layout

Make a choice between a single or double bowl washbasin and fill in positions 1-5 or 1-6 accordingly.

Next step is to define the size of the bowl(s) indicated by the  - symbol. Go to page 73 for Noon bowl sizes.

SINGLE

-  340 / 400 / 460mm
- ① max. 5000mm
- ② max. 550mm
- ③ min. 35mm
- ④ min. 30mm
- ⑤ min. 30mm
min. 50mm with overflow
min. 80mm with tap hole
min. 120mm with tap hole + overflow

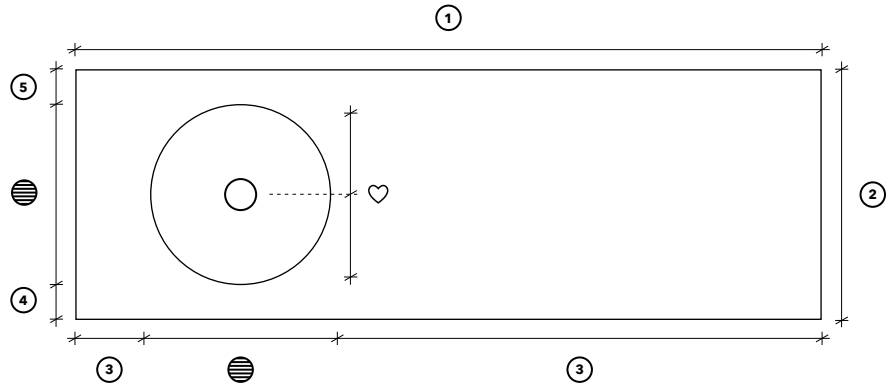

DOUBLE

-  340 / 400 / 460mm
- ① max. 5000mm
- ② max. 550mm
- ③ min. 35mm
- ④ min. 30mm
- ⑤ min. 30mm
min. 50mm with overflow
min. 80mm with tap hole
min. 120mm with tap hole + overflow
- ⑥ min. 50mm

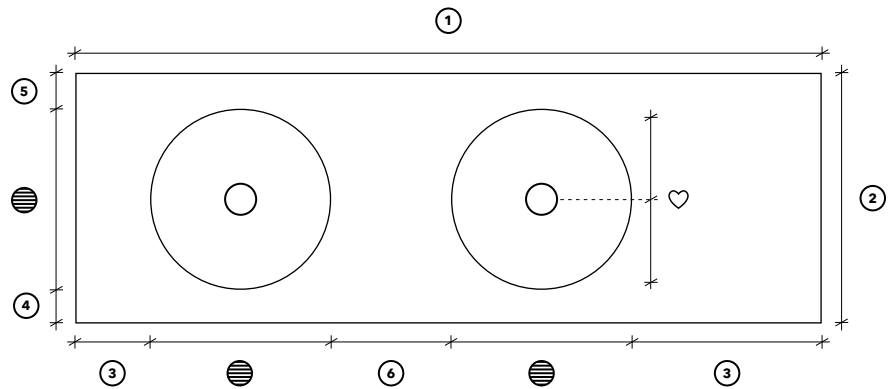

Edge

Noon washbasin can be supplied with a 12mm top or with an edge from 20mm up to 900mm. In order to conceal the bowl, Not Only White recommends an edge height of 150mm.

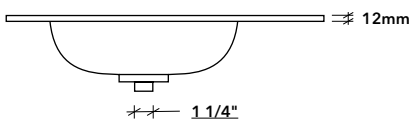

H12
12mm top sheet

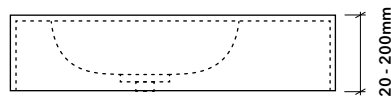

EH100
Edge 20 - 100mm high

EH150
Edge 101 - 150mm high

EH200
Edge 151 - 200mm high

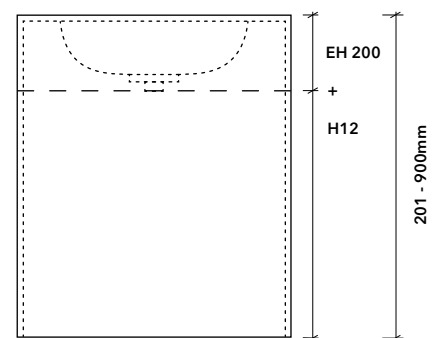

EH200 + remaining m² in H12
Edge 201 - 900mm high

XSG50
50mm plinth for floor-standing model

Bowls

CNN340

Ø340 x h114mm



CNN400

Ø400 x h124mm



CNN460

Ø460 x h134mm

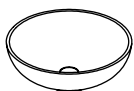

Tap hole

If you need to fit a top-mounted tap, we can pre-drill the hole (code **HH35**).

Consider the space you would need to secure the tap with a tightening ring.

Top-mounted tap without overflow:

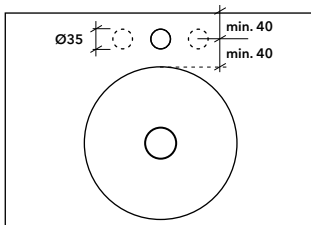

Top-mounted tap with overflow:

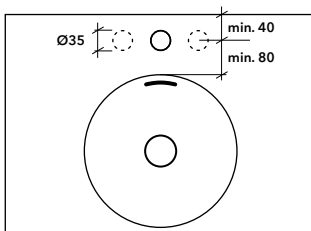

Cut-outs and edge finishes

Please refer to page 8.

Drain type

Depending on how the washbasin needs to look and work, you can choose from different drain types for Noon.

① FLUSH DRAIN free flow drain

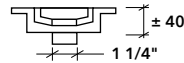

Noon bowls are standard equipped with our Flush drain. This drain allows water to flow through at all times and cannot be closed.

Flush drain is free of charge

② POP-DOWN DRAIN closable drain

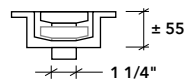

Our Pop-down drain has the same esthetical look as the Flush drain but it can be pressed down to close the drain.

Pop-down drain is calculated per bowl

For use with the Pop-down drain, Not Only White recommends to equip the bowl with an overflow.

③ DR72 DRAIN HOLE for a third party drain

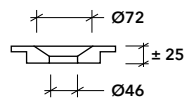

The DR72 drain hole is used for third party drains, both closable and non-closable.

DR72 drain is free of charge

Not Only White recommends to pair a third party closable drain with an overflow.

Basq trays

Noon washbasin can be supplied with a plateau on the side for Basq trays. Please refer to page 8.

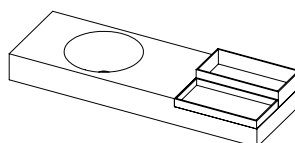

Overflow

An overflow (code **OH50**) is used for bowls equipped with a closable drain.

The overflow drain tube needs 50mm at the back of the washbasin to fit.

The overflow ring, that drains excess water into the drain, adds 30mm of height underneath the basin drain.

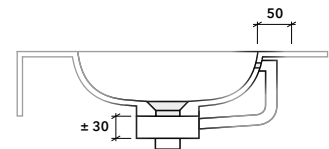

Integrated splashback

Not Only White offers an integrated splashback on Base washbasins (code **CSP90H**) with a maximum height of 90mm.

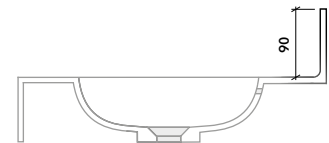

Note that a splashback with a height over 90mm will be supplied as a separate piece without a radius edge.

Brackets and ribs

Please refer to page 9, where brackets and ribs are explained, to find out what type of support is needed for your washbasin.

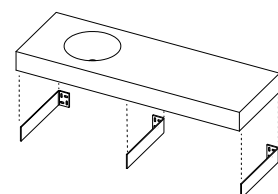

Materials and colours

Hi-Macs ○ White