

Blend handrinse

The Blend handrinse is the smaller version of the Blend basin. The top of the organic-shaped basin fluidly forms the 6 centimeters high splashback giving the Blend handrinse a nostalgic look.

The Blend handrinse is also available with an edge and both models are equipped with the Flush drain made out of Hi-Macs, just like the basin itself.



product
design
award

2011

Specifications

- with our Flush drain
- delivered as wall-mounted version including white powder coated bracket
- standard size tap hole Ø30mm

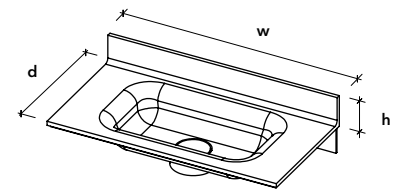

d260mm - no tap hole

HBL02
w500 x d260 x h69mm
bowl w290 x d144 x h60mm

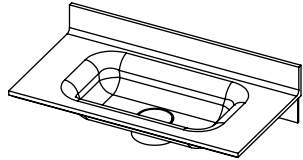

HBL03
w600 x d260 x h69mm
bowl w290 x d144 x h60mm

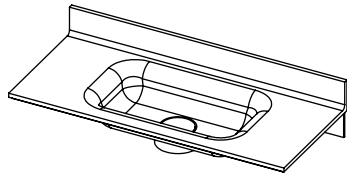

HBL04
w500 x d260 x h69mm
bowl w290 x d144 x h60mm

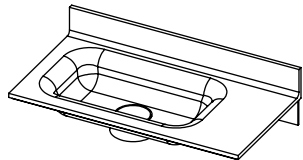

HBL05
w600 x d260 x h69mm
bowl w290 x d144 x h60mm

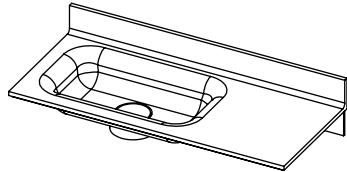

HBL06
w500 x d260 x h69mm
bowl w290 x d144 x h60mm

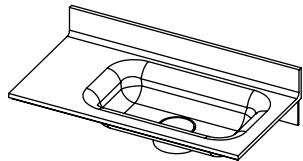

HBL07
w600 x d260 x h69mm
bowl w290 x d144 x h60mm

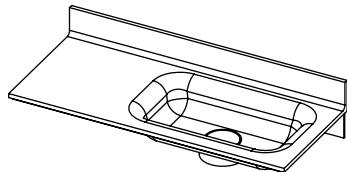

d260mm - with tap hole

HBL08
w500 x d260 x h69mm
bowl w290 x d144 x h60mm

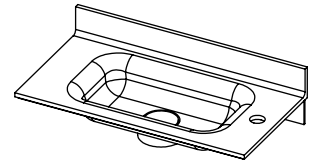

HBL09
w500 x d260 x h69mm
bowl w290 x d144 x h60mm

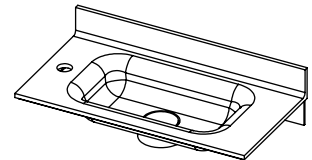

HBL10
w600 x d260 x h69mm
bowl w290 x d144 x h60mm

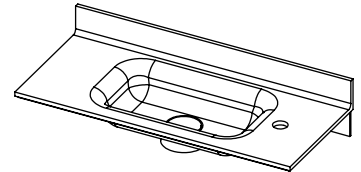

HBL11
w600 x d260 x h69mm
bowl w290 x d144 x h60mm

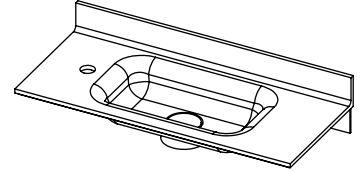

HBL12
w500 x d260 x h69mm
bowl w290 x d144 x h60mm

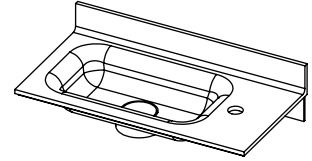

HBL13
w600 x d260 x h69mm
bowl w290 x d144 x h60mm

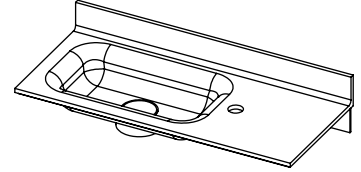

HBL14
w500 x d260 x h69mm
bowl w290 x d144 x h60mm

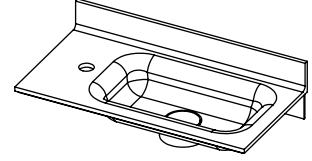

HBL15
w600 x d260 x h69mm
bowl w290 x d144 x h60mm

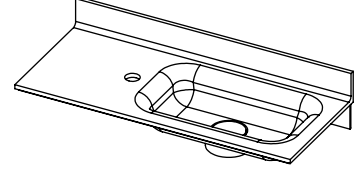

Blend handrinse



What makes the Blend collection so special is the fusion of the organic-shaped bowl with the linear top. The invisible design of the Flush drain fits the Blend perfectly. Blend invites you to touch it.

The curved design of the bowl allows for easy maintenance.

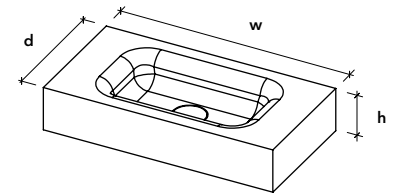

Specifications

- with our Flush drain
- delivered as wall-mounted version including mounting holes in the back edge
- standard size tap hole $\varnothing 30\text{mm}$
- Blend handrinse Models HBL16 -30 are also available in top-mounted versions

d260mm - no tap hole

HBL16
w400 x d260 x h95mm
bowl w290 x d144 x h60mm

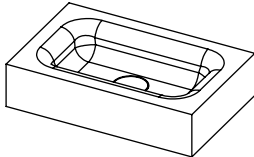

HBL17
w500 x d260 x h95mm
bowl w290 x d144 x h60mm

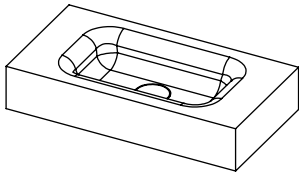

HBL18
w600 x d260 x h95mm
bowl w290 x d144 x h60mm

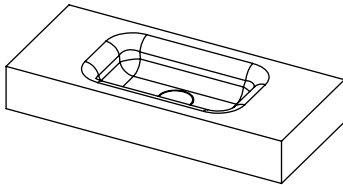

HBL19
w500 x d260 x h95mm
bowl w290 x d144 x h60mm

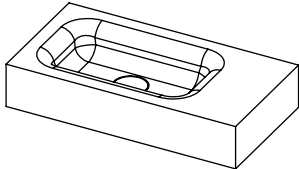

HBL20
w600 x d260 x h95mm
bowl w290 x d144 x h60mm

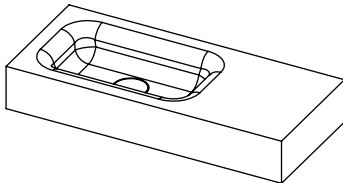

HBL21
w500 x d260 x h95mm
bowl w290 x d144 x h60mm

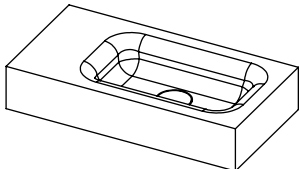

HBL22
w600 x d260 x h95mm
bowl w290 x d144 x h60mm

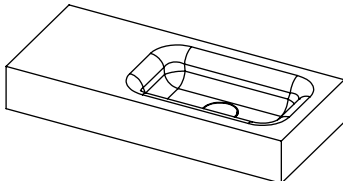

d260mm - with tap hole

HBL23
w500 x d260 x h95mm
bowl w290 x d144 x h60mm

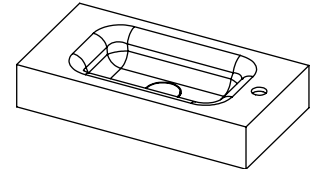

HBL24
w500 x d260 x h95mm
bowl w290 x d144 x h60mm

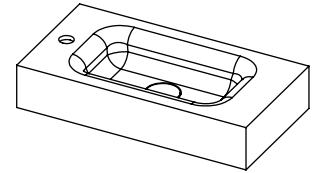

HBL25
w600 x d260 x h95mm
bowl w290 x d144 x h60mm

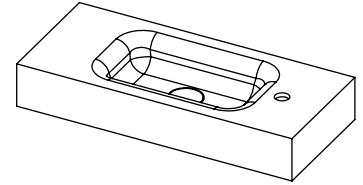

HBL26
w600 x d260 x h95mm
bowl w290 x d144 x h60mm

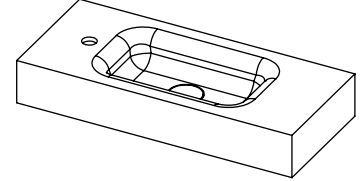

HBL27
w500 x d260 x h95mm
bowl w290 x d144 x h60mm

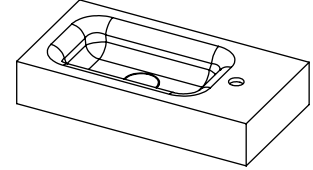

HBL28
w600 x d260 x h95mm
bowl w290 x d144 x h60mm

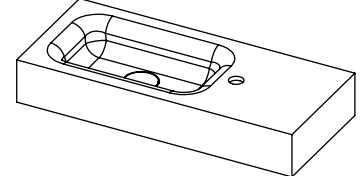

HBL29
w500 x d260 x h95mm
bowl w290 x d144 x h60mm

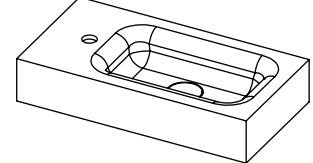

HBL30
w600 x d260 x h95mm
bowl w290 x d144 x h60mm

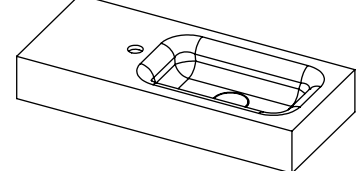

Handrinse layout

Fill in positions 1 and 2.

- ① max. 5000mm
- ② min. 205mm
min. 245mm with tap hole

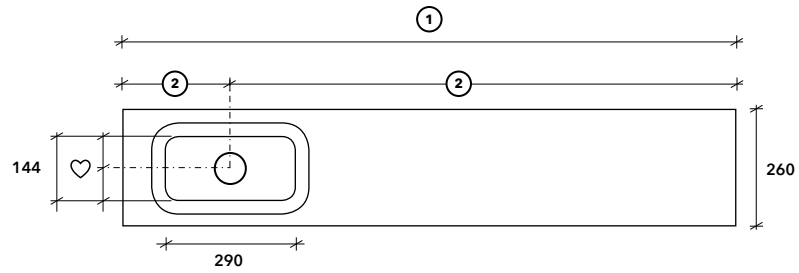

Edge

Blend handrinse always comes with a front and back edge. In order to conceal the bowl, Not Only White recommends an edge height of 95mm.

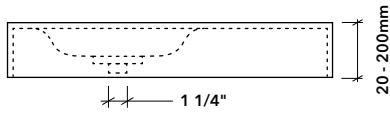

EH100
Edge 20 - 100mm high

EH150
Edge 101 - 150mm high

EH200
Edge 151 - 200mm high

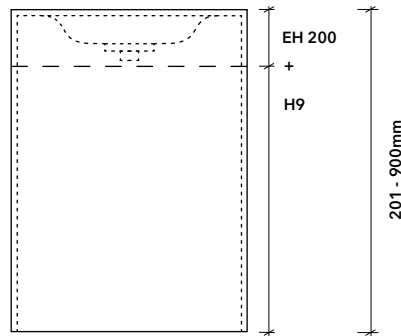

EH200 + remaining m² in H9
Edge 201 - 900mm high

XSG50
50mm plinth for floor-standing model

Bowls

CHBL29146
w290 x d144 x h60mm



Drain type

Depending on how the handrinse basin needs to look and work, you can choose from different drain types for Blend handrinse.

① **FLUSH DRAIN**
free flow drain

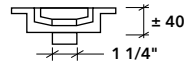

Blend handrinse bowls are standard equipped with our Flush drain. This drain allows water to flow through at all times and cannot be closed.

Flush drain is free of charge

② **POP-DOWN DRAIN**
closable drain

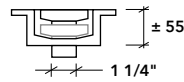

Contact us for information.

③ **DR72 DRAIN HOLE**
for a third party drain

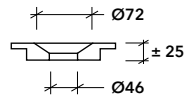

The DR72 drain hole is used for third party drains.

Not Only White recommends to use a free flow drain.

DR72 drain is free of charge

Overflow

Contact us for information.

Tap hole

If you need to fit a top-mounted tap, we can pre-drill the hole (code **HH35**).

Consider the space you would need to secure the tap with a tightening ring.

Top-mounted tap without overflow:

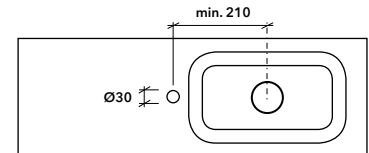

Mounting holes

To install a handrinse basin to the wall, Not Only White can provide mounting holes (code **OVHL**) in the back edge.

Handrinse basins up to 600mm need two holes. Any handrinse basin wider than 600mm, we advise to have an extra hole up to 1.2m and two extra holes up to 2m.

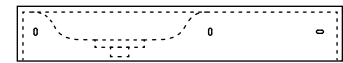

Cut-outs and edge finishes

Please refer to page 8.

Materials and colours

Hi-Macs

White