



## Base



The Base collection consists of basic-shaped basins especially designed for the contract market. It is characterized by the 12mm radius inside the basin. This collection aims to be accessible, adaptable and easy to maintain.

Not only is Base perfect for the domestic environment, but its characteristics also make Base an ideal choice in hygienic surroundings and intensively-used restrooms, such as hospitals, exhibition centers or airports.

Design by Marike Andeweg

○ White Himacs



Washbasin layout

Make a choice between a single or double bowl washbasin and fill in positions 1-5 or 1-6 accordingly. Next step is to define the size of the bowl(s) indicated by the  - symbol. Go to page 24 and 25 for Base bowl sizes.

SINGLE

-  bowl size
- ① max. 5000mm
- ② max. 550mm
- ③ min. 35mm
- ④ min. 30mm
- ⑤ min. 30mm  
min. 50mm with overflow  
min. 80mm with tap hole  
min. 120mm with tap hole + overflow

Note: when ordering only a top with bowl(s), sizes 3, 4 and 5 need to be adjusted according to the cabinet construction.

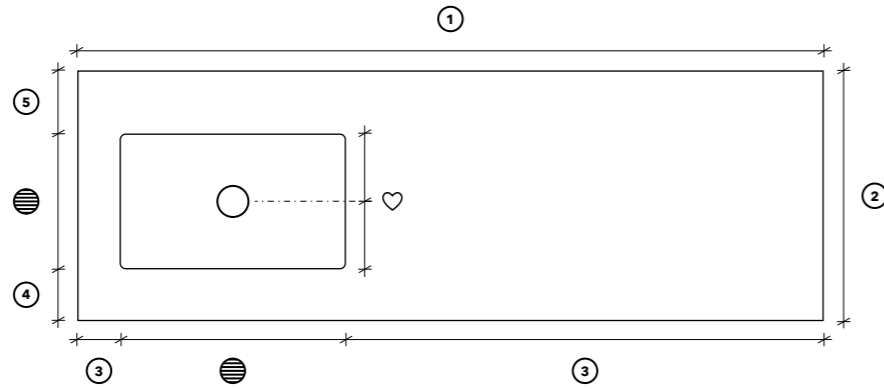

DOUBLE

-  bowl size
- ① max. 5000mm
- ② max. 550mm
- ③ min. 35mm
- ④ min. 30mm
- ⑤ min. 30mm  
min. 50mm with overflow  
min. 80mm with tap hole  
min. 120mm with tap hole + overflow
- ⑥ min. 50mm

Note: when ordering only a top with bowl(s), sizes 3, 4 and 5 need to be adjusted according to the cabinet construction.

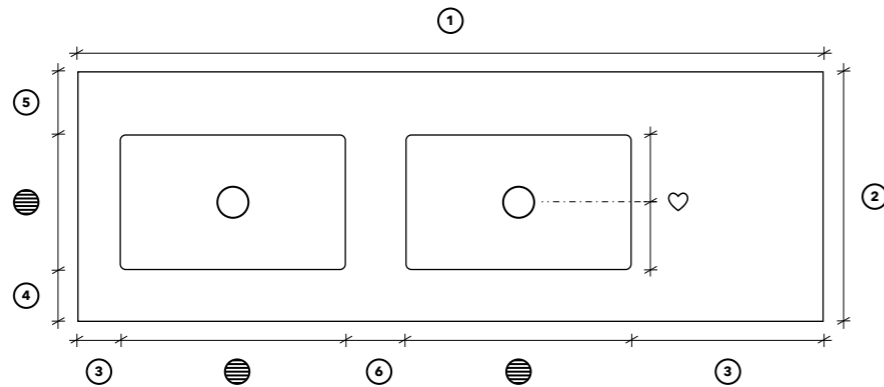

Edge

Base washbasin can be supplied with a 12mm top or with an edge from 20mm up to 900mm. In order to conceal the bowl, Not Only White recommends an edge height as mentioned on pages 24 and 25 at the 'Bowls' section.

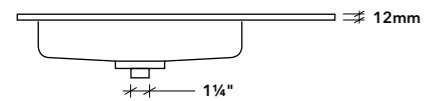

H12  
12mm top sheet

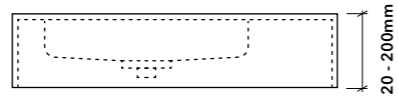

EH100  
Edge 20 - 100mm high

EH150  
Edge 101 - 150mm high

EH200  
Edge 151 - 200mm high

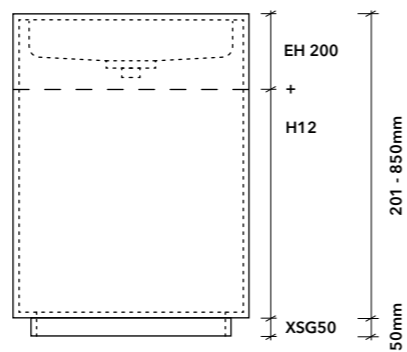

EH200 + remaining m<sup>2</sup> in H12  
Edge 201 - 850mm high

XSG50  
50mm plinth for floor-standing model

Tap hole

If you need to fit a top-mounted tap, we can pre-drill the hole (code **HH35**).

Consider the space you would need to secure the tap with a tightening ring.

Top-mounted tap without overflow:

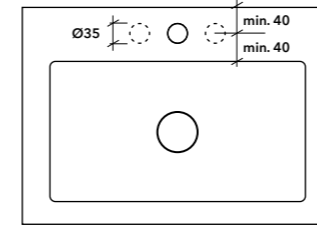

Top-mounted tap with overflow:

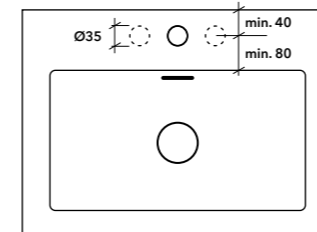

Basq trays

Base washbasin can be supplied with a plateau on the side for Basq trays. Please refer to page 10 and 45.

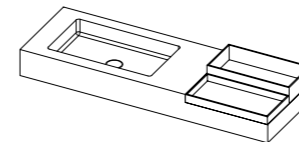

Brackets and ribs

Please refer to page 11, where brackets and ribs are explained, to find out what type of support is needed for your washbasin.

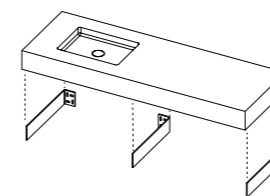

Drain type

Depending on how the washbasin needs to look and work, you can choose from different drain types for Base.

① FLUSH DRAIN  
free flow drain

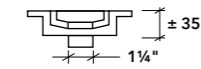

Base bowls are standard equipped with our Flush drain. This drain allows water to flow through at all times and cannot be closed.

Flush drain is free of charge

② POP-DOWN DRAIN  
closable drain

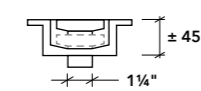

Our Pop-down drain has the same aesthetic as the Flush drain but it can be pressed down to close the drain.

Pop-down drain is calculated per bowl

For use with the Pop-down drain, Not Only White recommends to equip the bowl with an overflow.

③ DR72 DRAIN HOLE  
for a third party drain

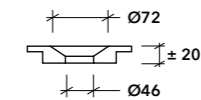

The DR72 drain hole is used for third party drains, both closable and non-closable.

DR72 drain is free of charge

Not Only White recommends to pair a third party closable drain with an overflow.

Note: when choosing a pop-down drain we recommend an overflow and extra edge height of 45mm. With a pop-down drain only we recommend an extra edge height of 15mm.

Overflow

An overflow (code **OH50**) is used for bowls equipped with a closable drain.

The overflow drain tube needs 50mm at the back of the washbasin to fit.

The overflow ring, that drains excess water into the drain, adds 30mm of height underneath the basin drain.

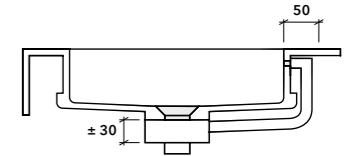

Integrated backsplash

Not Only White offers an integrated backsplash on Base washbasins (code **CSP90H**) with a maximum height of 90mm.

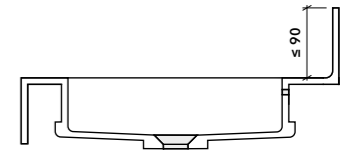

Note that a backsplash with a height over 90mm will be supplied as a separate piece without a radius edge.

Separate backsplash is calculated per m<sup>2</sup>

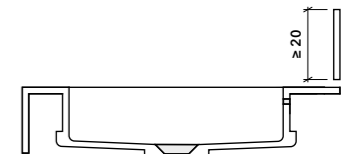

Cut-outs and edge finishes

Please refer to page 10.

Materials and colors

Himacs  White

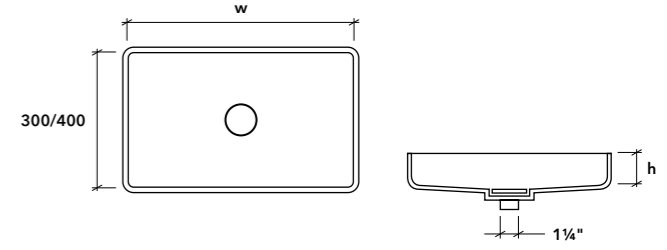
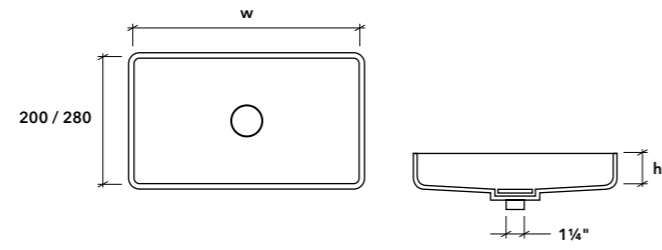

**Bowls - 280mm**

**Bowls - depth 300mm**

w400mm x d280mm

w1000mm x d280mm

w400mm x d300mm

w1000mm x d300mm

**CBS40285**  
w400 x d280 x h50mm  
rec. edge height 90mm

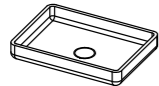

**CBS100285**  
w1000 x d280 x h50mm  
rec. edge height 100mm

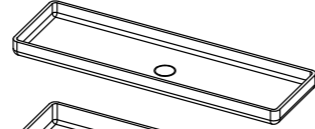

**CBS40305**  
w400 x d300 x h50mm  
rec. edge height 90mm

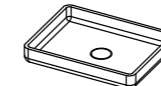

**CBS100305**  
w1000 x d300 x h50mm  
rec. edge height 100mm

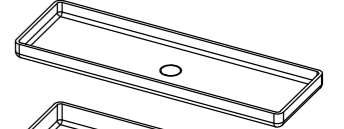

**CBS40287**  
w400 x d280 x h75mm  
rec. edge height 115mm

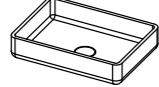

**CBS100287**  
w1000 x d280 x h75mm  
rec. edge height 125mm

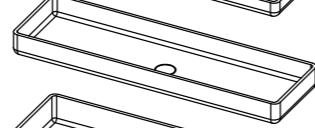

**CBS40307**  
w400 x d300 x h75mm  
rec. edge height 115mm

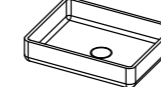

**CBS100307**  
w1000 x d300 x h75mm  
rec. edge height 125mm



**CBS402810**  
w400 x d280 x h100mm  
rec. edge height 140mm

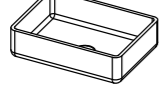

**CBS1002810**  
w1000 x d280 x h100mm  
rec. edge height 150mm

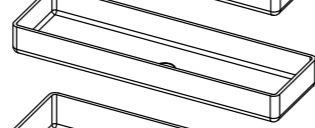

**CBS403010**  
w400 x d300 x h100mm  
rec. edge height 140mm



**CBS1003010**  
w1000 x d300 x h100mm  
rec. edge height 150mm



**CBS402815**  
w400 x d280 x h150mm  
rec. edge height 190mm



**CBS1002815**  
w1000 x d280 x h150mm  
rec. edge height 200mm

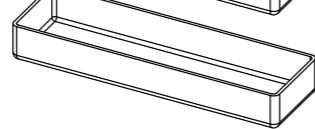

**CBS403015**  
w400 x d300 x h150mm  
rec. edge height 190mm



**CBS1003015**  
w1000 x d300 x h150mm  
rec. edge height 200mm

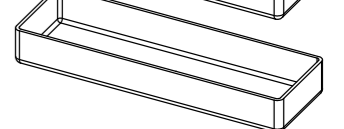

w500mm x d280mm

w500mm x d300mm

**CBS50285**  
w500 x d280 x h50mm  
rec. edge height 95mm

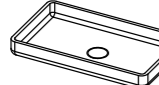

**CBS50305**  
w500 x d300 x h50mm  
rec. edge height 95mm

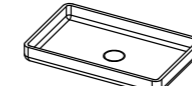

**CBS50287**  
w500 x d280 x h75mm  
rec. edge height 120mm



**CBS50307**  
w500 x d300 x h75mm  
rec. edge height 120mm

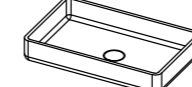

**CBS502810**  
w500 x d280 x h100mm  
rec. edge height 145mm

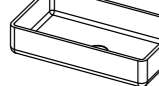

**CBS503010**  
w500 x d300 x h100mm  
rec. edge height 145mm



**CBS502815**  
w500 x d280 x h150mm  
rec. edge height 195mm



**CBS503015**  
w500 x d300 x h150mm  
rec. edge height 195mm

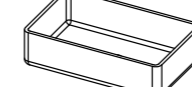

w800mm x d280mm

w300mm x d200mm

w800mm x d300mm

w400/500/650mm x d400mm

**CBS80285**  
w800 x d280 x h50mm  
rec. edge height 100mm

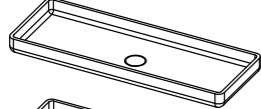

**CBS30205**  
w300 x d200 x h50mm  
rec. edge height 90mm



**CBS80305**  
w800 x d300 x h50mm  
rec. edge height 100mm

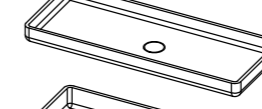

**CBS80287**  
w800 x d280 x h75mm  
rec. edge height 125mm



**CBS30207**  
w300 x d200 x h75mm  
rec. edge height 115mm



**CBS80307**  
w800 x d300 x h75mm  
rec. edge height 125mm

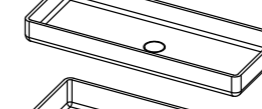

**CBS802810**  
w800 x d280 x h100mm  
rec. edge height 150mm



**CBS302010**  
w300 x d200 x h100mm  
rec. edge height 140mm

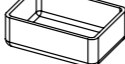

**CBS803010**  
w800 x d300 x h100mm  
rec. edge height 150mm



**CBS802815**  
w800 x d280 x h150mm  
rec. edge height 200mm



**CBS302015**  
w300 x d200 x h150mm  
rec. edge height 190mm

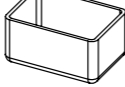

**CBS803015**  
w800 x d300 x h150mm  
rec. edge height 200mm



**For basin tops with a deep projection:  
Bowls with depth of 400mm**

**CBS404010**  
w400 x d400 x h100mm  
rec. edge height 140mm

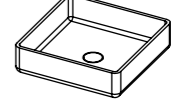

**CBS504010**  
w500 x d400 x h100mm  
rec. edge height 145mm

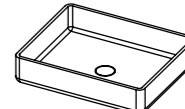

**CBS654010**  
w650 x d400 x h100mm  
rec. edge height 150mm

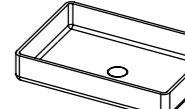

**For basin tops with short projection:  
Bowls with depth of only 200mm**